



GRIND PROJECTS

**DESIGN SUMMARY:**

The King Island skatepark is in need of an upgrade. Some of the obstacles have become unsafe to use and need to be removed.

While the skatepark is a relatively good size, it lacks variety and the basic elements needed for doing the majority of tricks.

Adding both steel and concrete edges to the proposed elements enable riders to learn different techniques and enables them to do actual tricks! By incorporating hips, corners and different angles the design allows users to flow around the whole park using all the elements in a variety of ways.

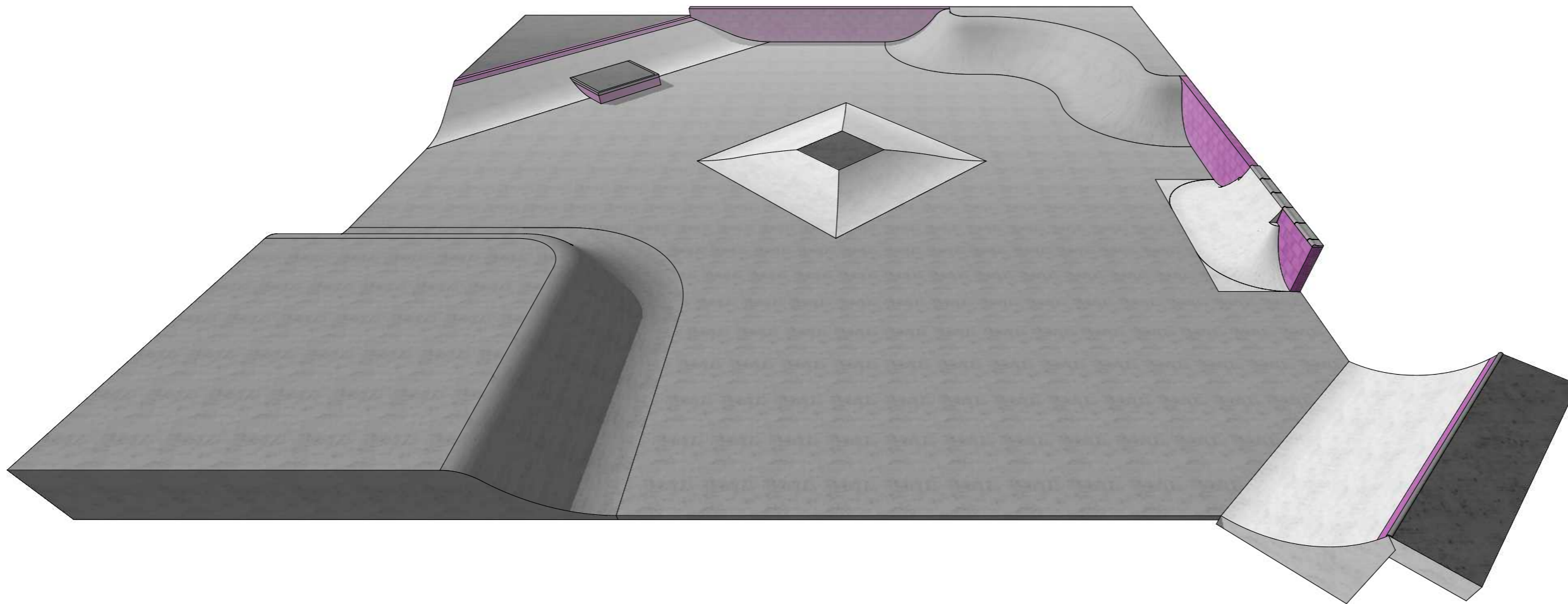

**PERSPECTIVE VIEW 1**

scale - N.T.S.

B	09.04.18	Updated plans for construction
A	09.04.18	Revised design for construction
No.	DATE	REVISION



GRIND PROJECTS

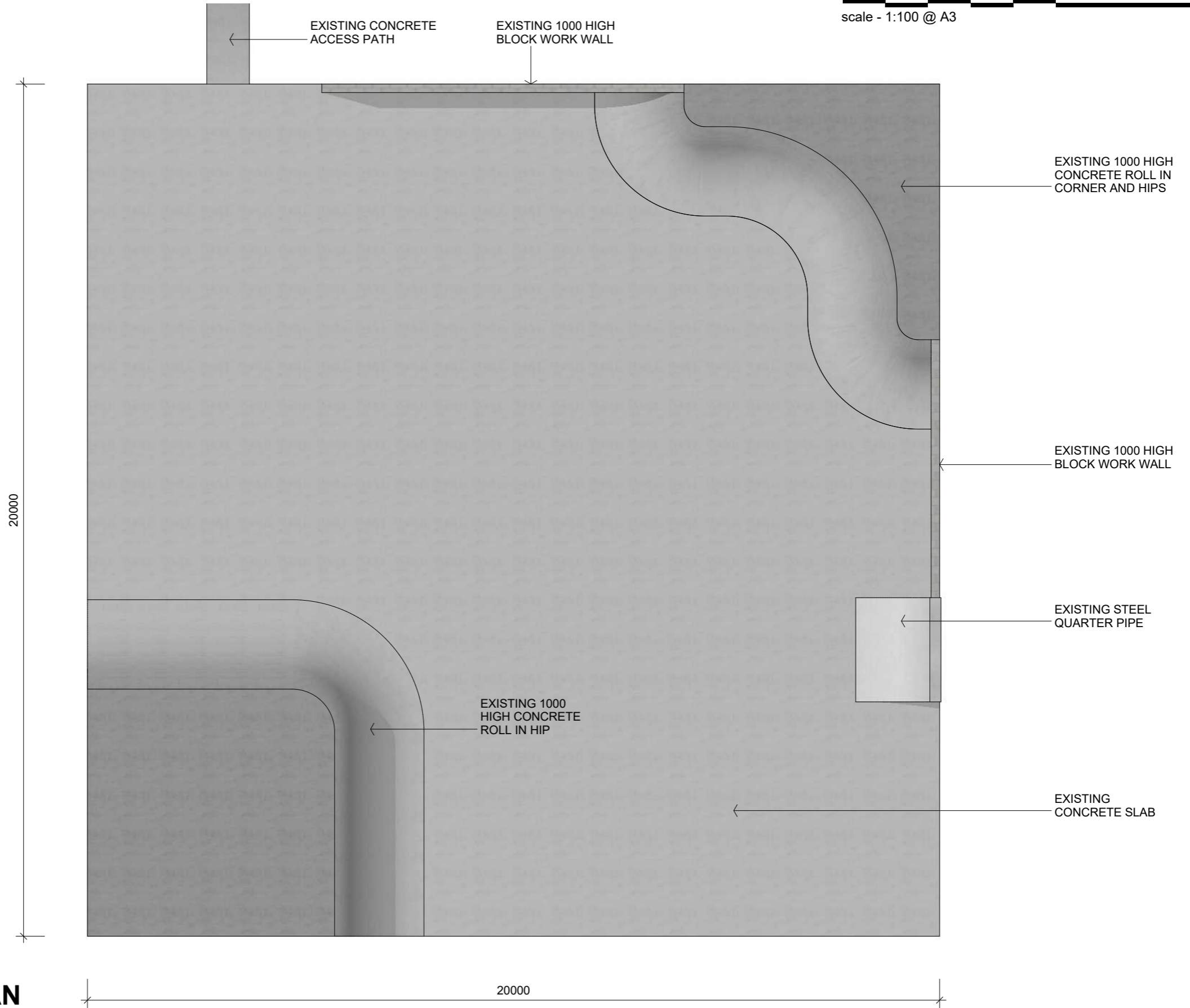
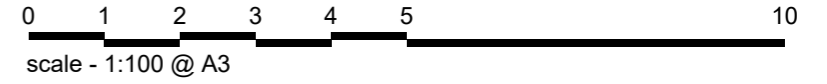

EXISTING CONDITIONS PLAN

scale - 1:100 @ A3



B	09.04.18	Updated plans for construction
A	09.04.18	Revised design for construction
No.	DATE	REVISION

These drawings are protected by copyright and remain the property of the designer and shall not be reproduced in part, or full, without the written permission from the designer.



GRIND PROJECTS

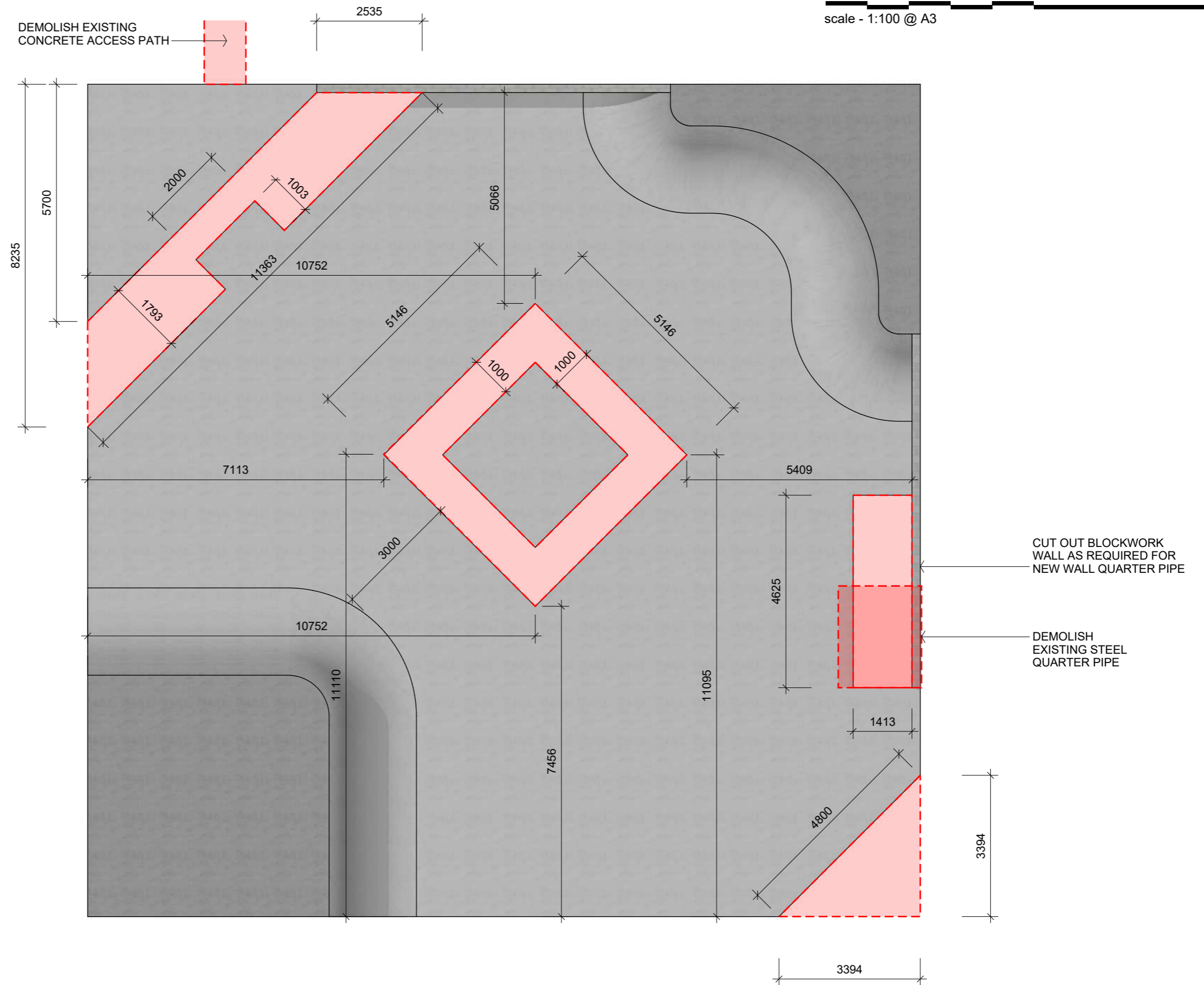
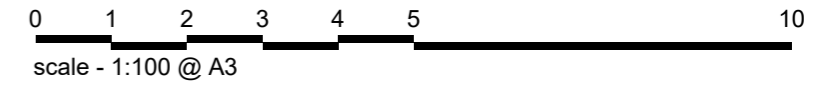

**DEMOLITION PLAN**  
scale - 1:100 @ A3



No.	DATE	REVISION
B	09.04.18	Updated plans for construction
A	09.04.18	Revised design for construction

REF: 1614 REV: B DATE: 09.04.18

These drawings are protected by copyright and remain the property of the designer and shall not be reproduced in part, or full, without the written permission from the designer.



GRIND PROJECTS

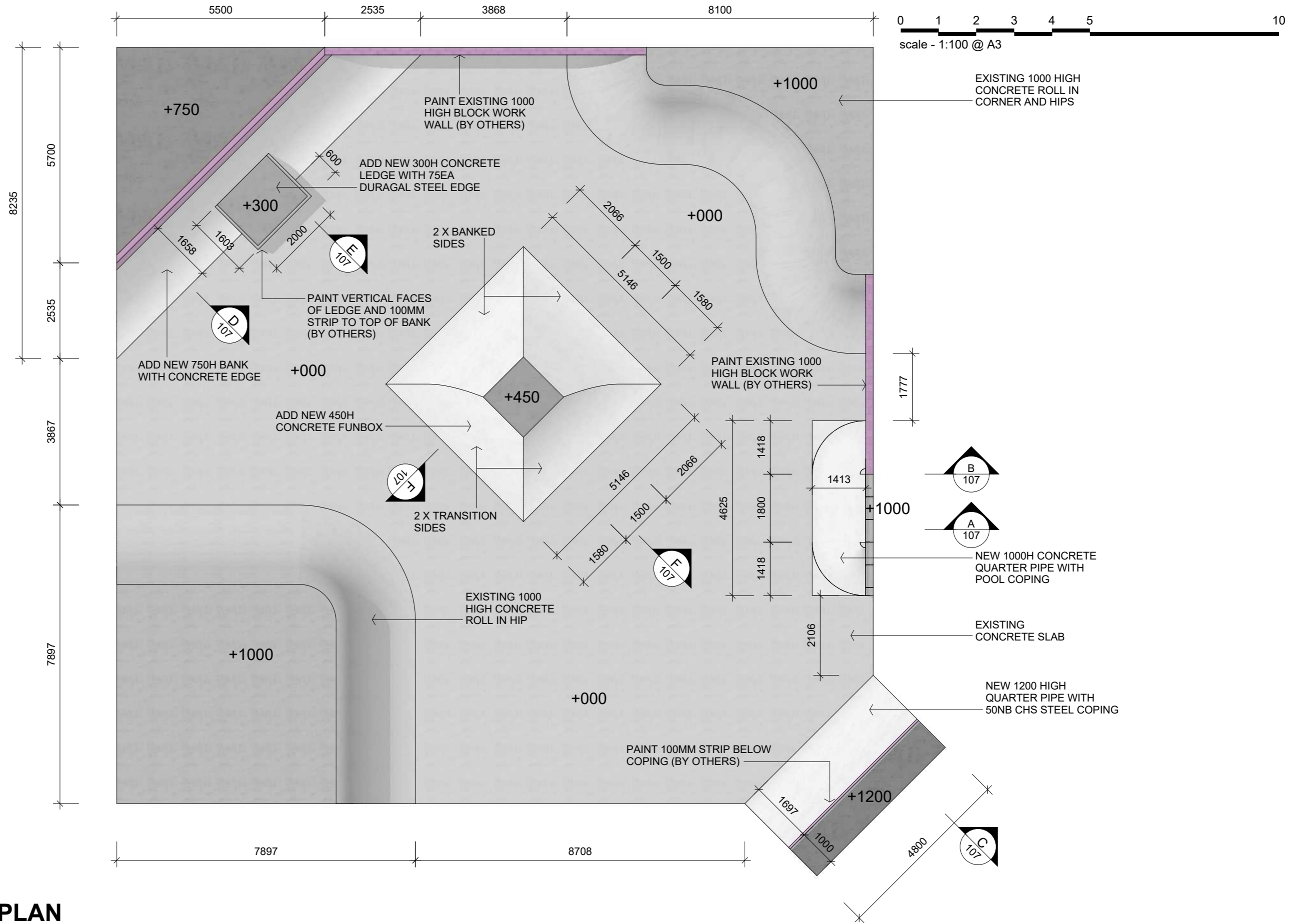

**RENOVATION PLAN**

scale - 1:100 @ A3



KING ISLAND COUNCIL - SKATEPARK RENOVATION - RENOVATION PLAN



No.	DATE	REVISION
B	09.04.18	Updated plans for construction
A	09.04.18	Revised design for construction

REF: 1614 REV: B DATE: 09.04.18

These drawings are protected by copyright and remain the property of the designer and shall not be reproduced in part, or full, without the written permission from the designer.



GRIND PROJECTS

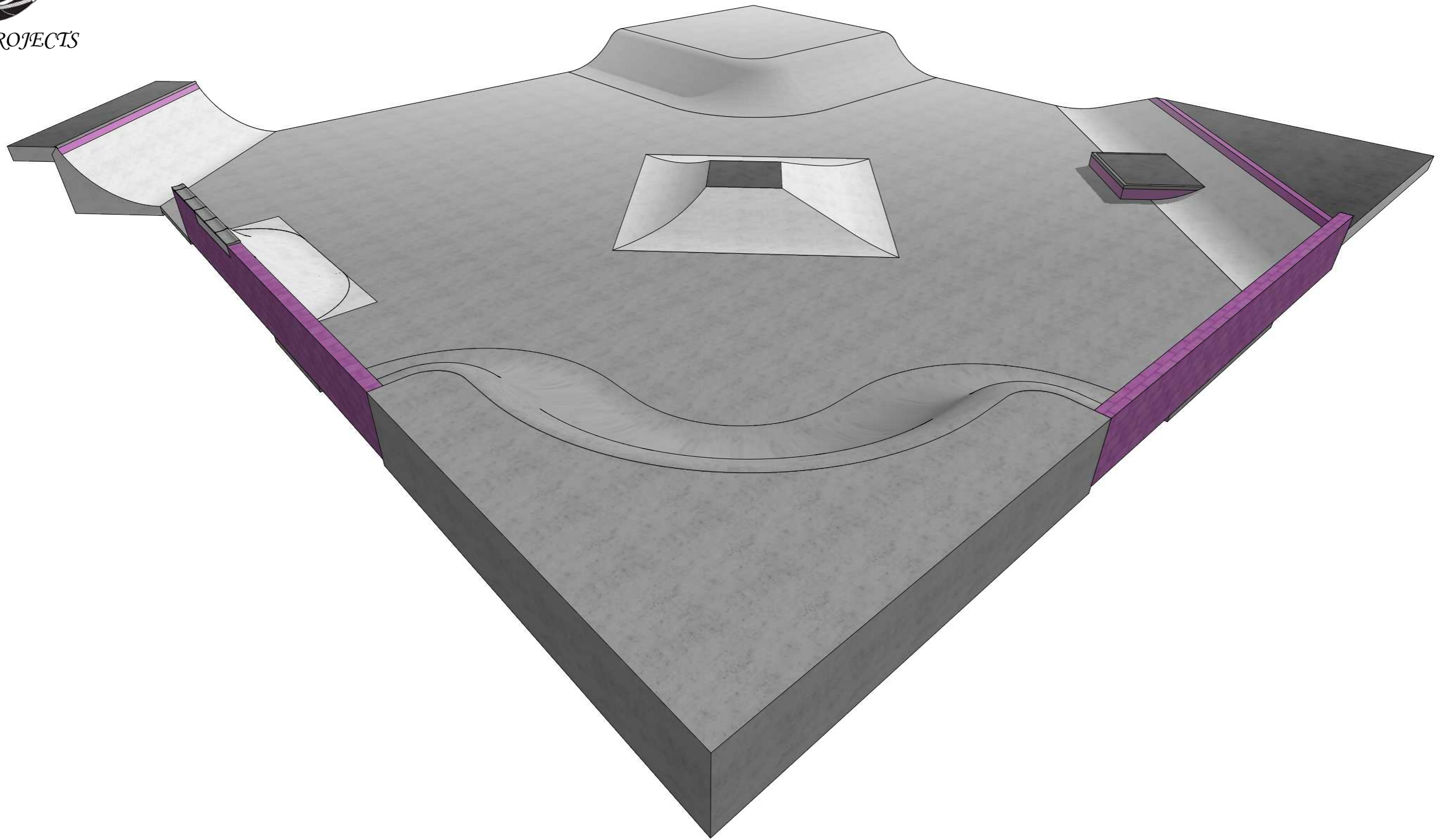

### PERSPECTIVE VIEW 2

scale - N.T.S. @ A3



B	09.04.18	Updated plans for construction
A	09.04.18	Revised design for construction
No.	DATE	REVISION



GRIND PROJECTS

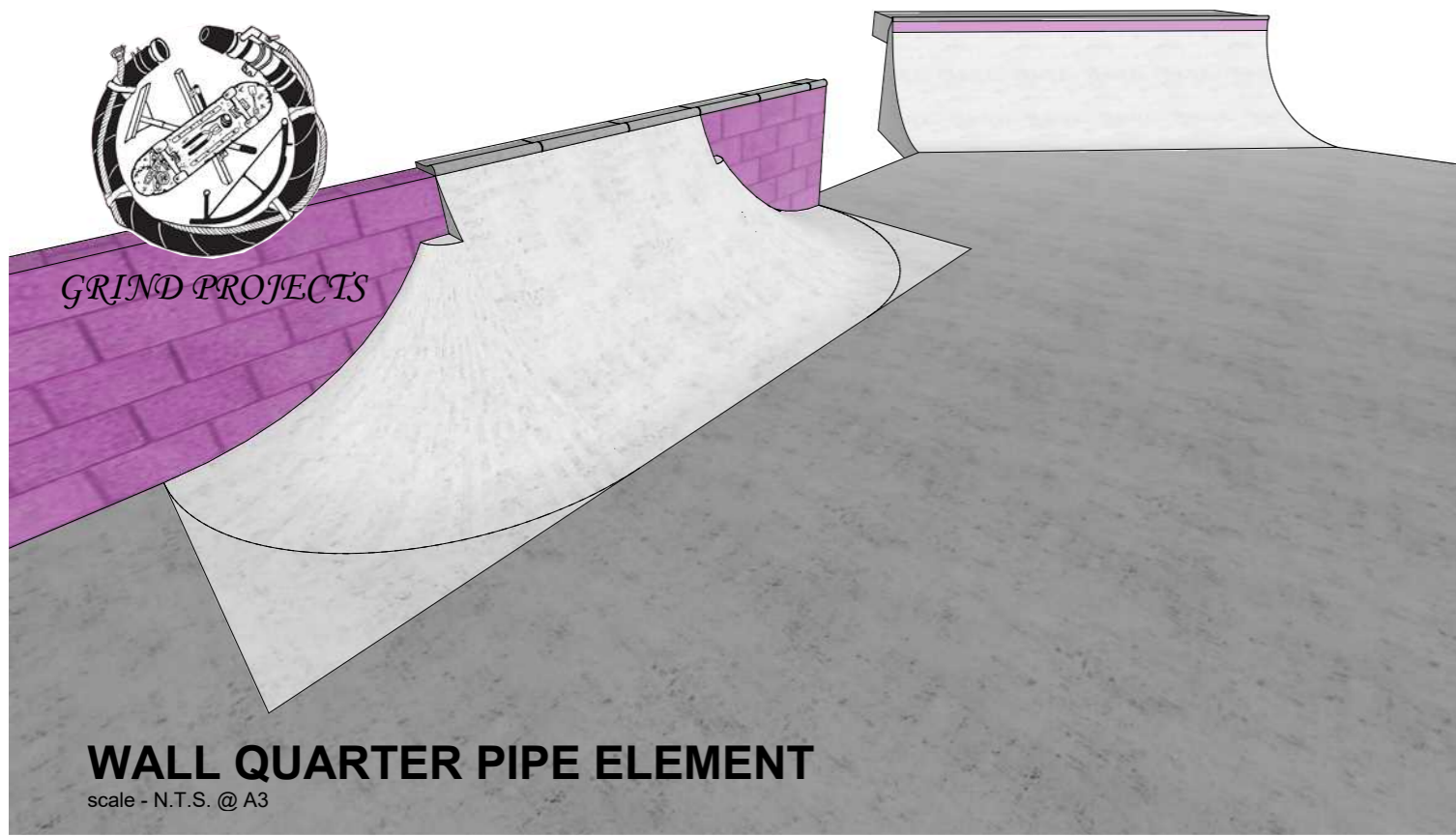

### WALL QUARTER PIPE ELEMENT

scale - N.T.S. @ A3

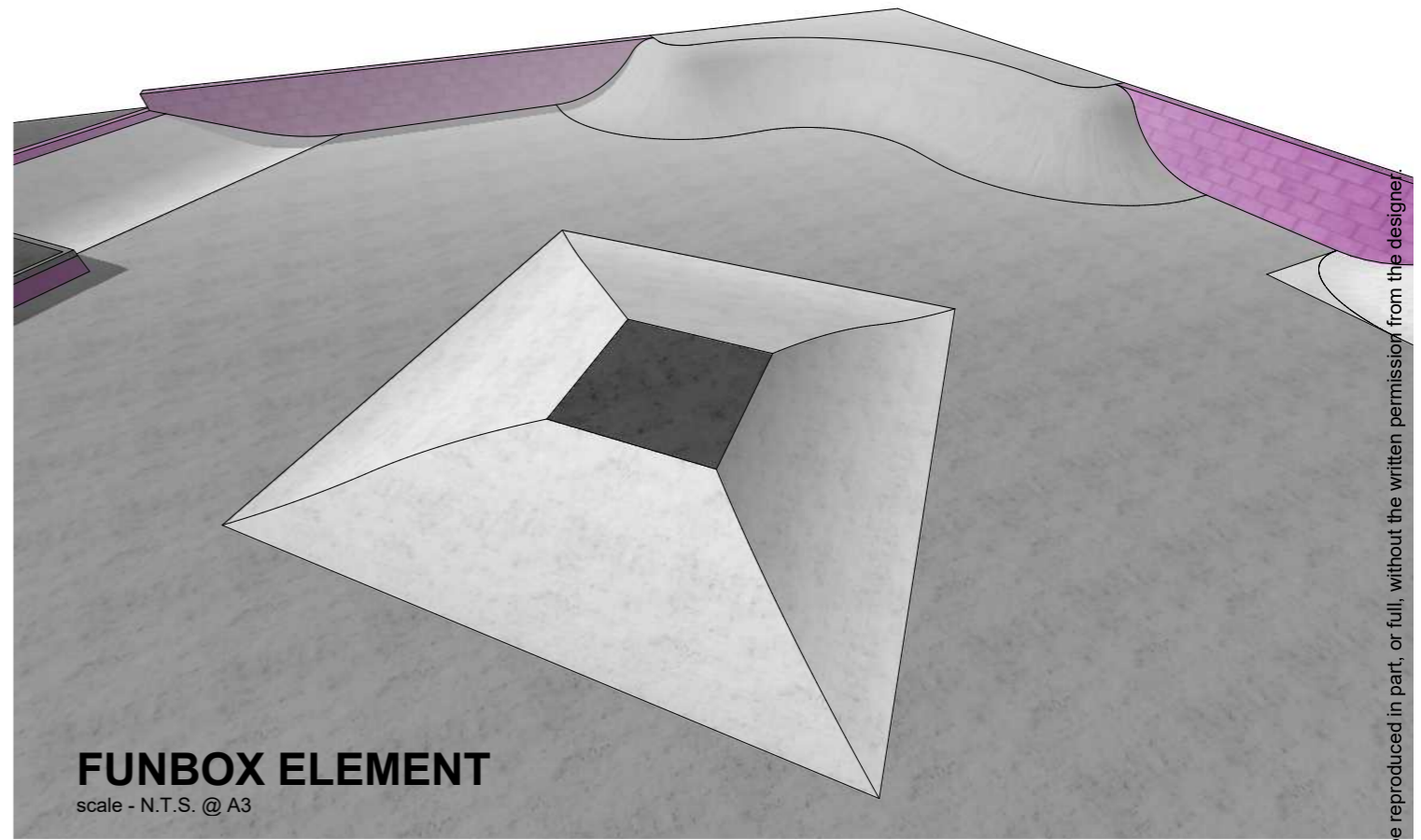

### FUNBOX ELEMENT

scale - N.T.S. @ A3

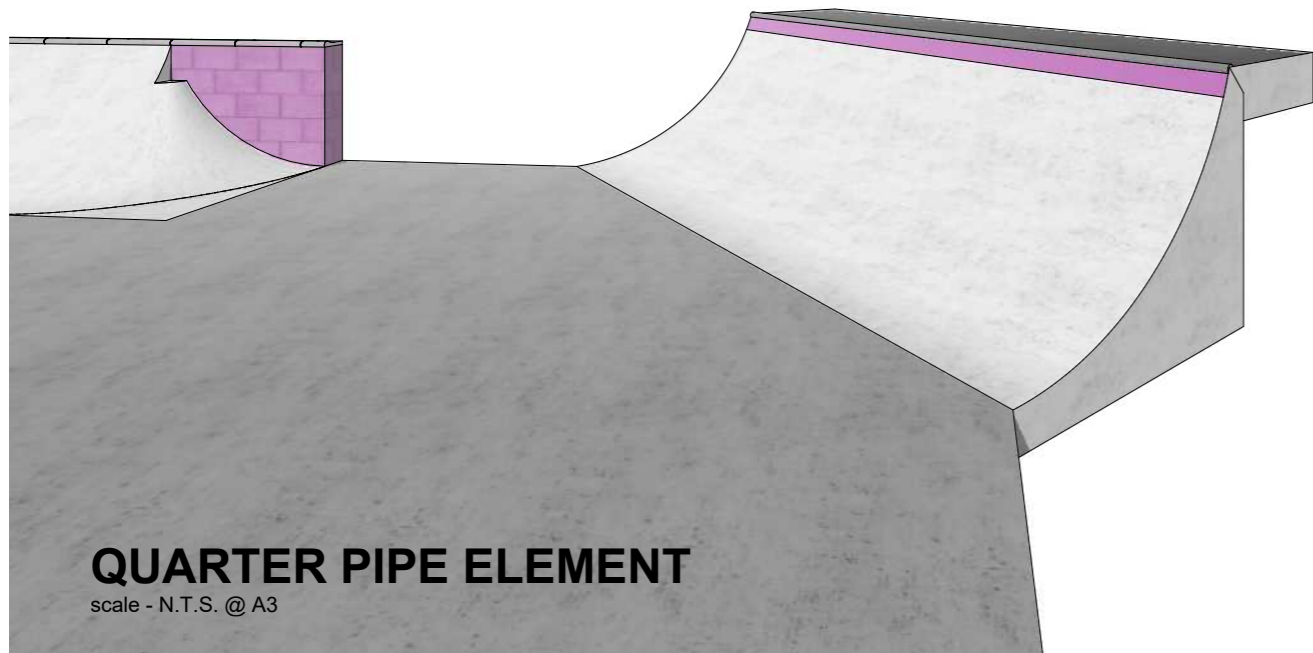

### QUARTER PIPE ELEMENT

scale - N.T.S. @ A3

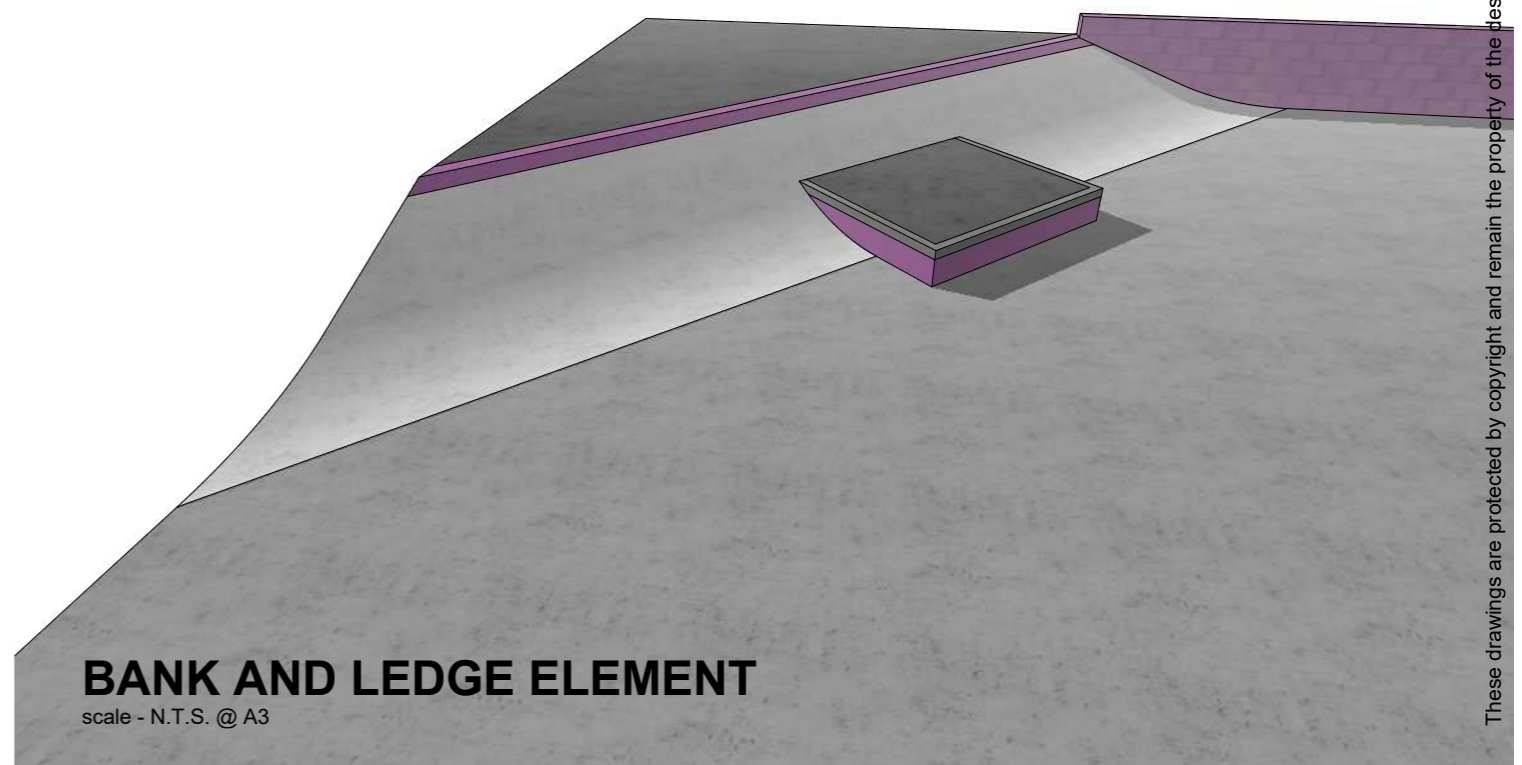

### BANK AND LEDGE ELEMENT

scale - N.T.S. @ A3

These drawings are protected by copyright and remain the property of the designer and shall not be reproduced in part, or full, without the written permission from the designer.

B	09.04.18	Updated plans for construction
A	09.04.18	Revised design for construction
No.	DATE	REVISION



GRIND PROJECTS

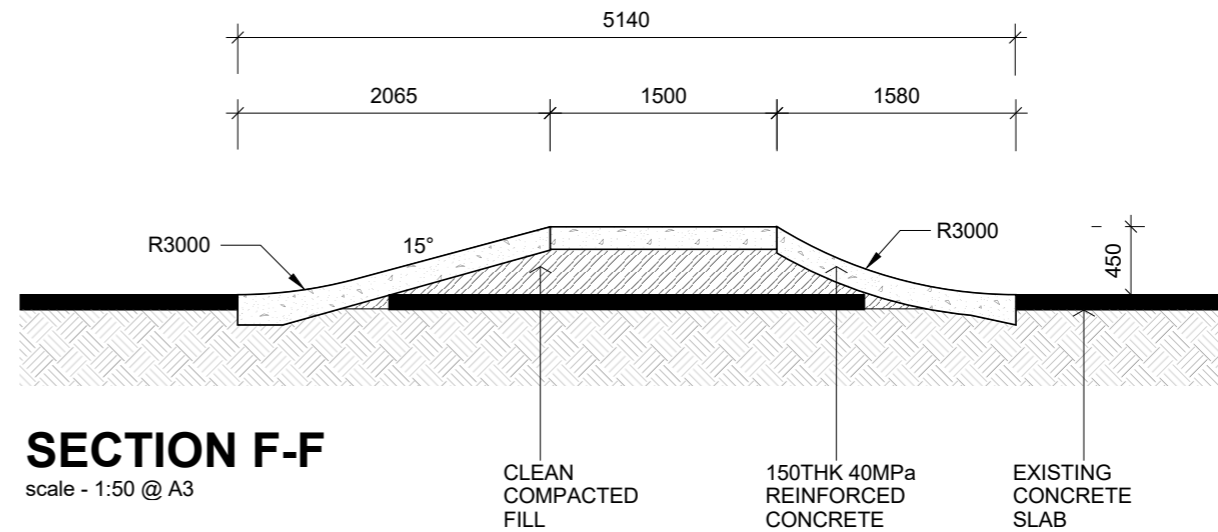
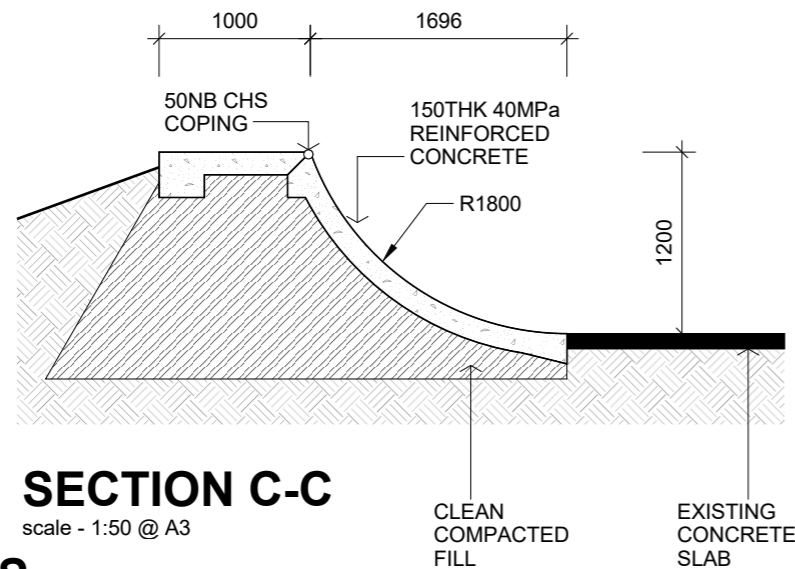
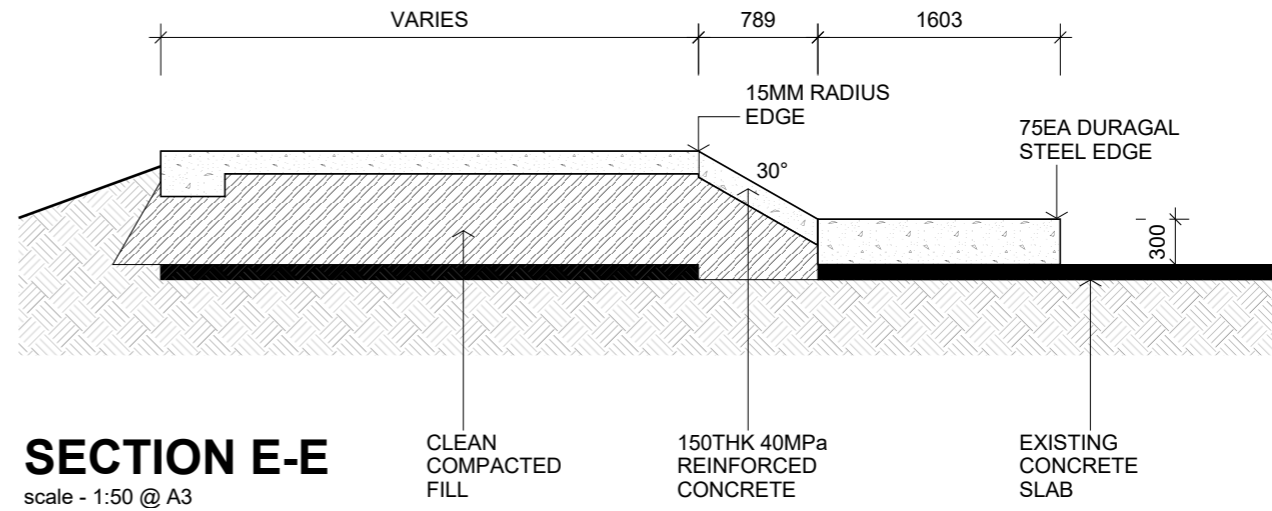
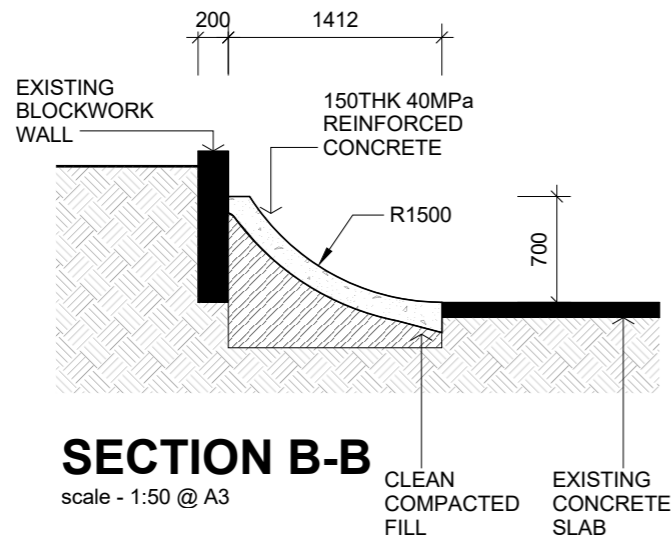
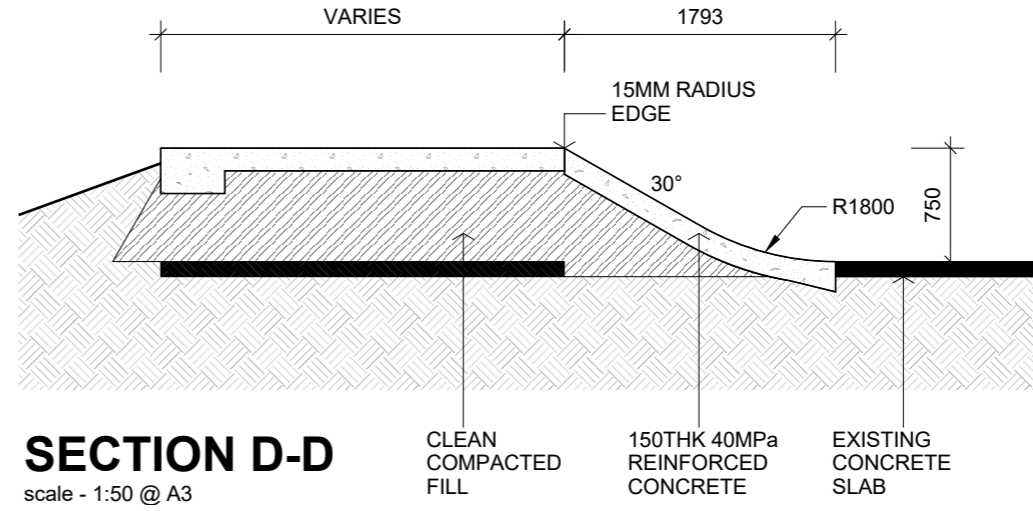
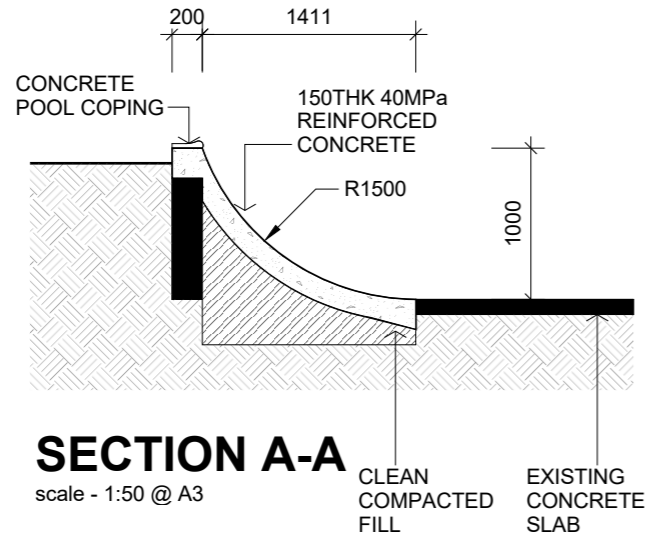

**CROSS SECTIONS**  
scale - 1:50 @ A3

These drawings are protected by copyright and remain the property of the designer and shall not be reproduced in part, or full, without the written permission from the designer.



B	09.04.18	Updated plans for construction
A	09.04.18	Revised design for construction
No.	DATE	REVISION
REF: 1614		REV: B DATE: 09.04.18



GRIND PROJECTS

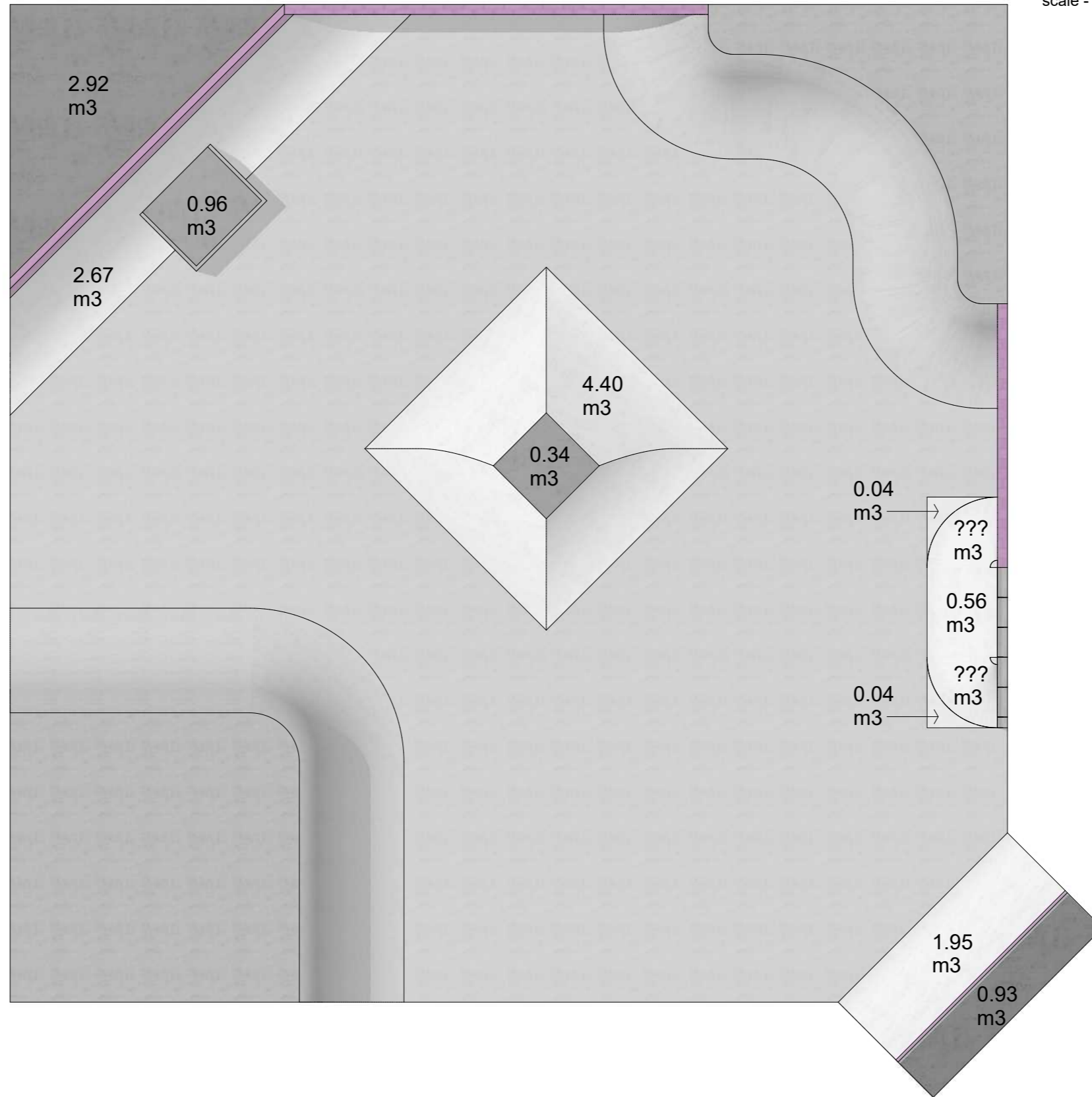
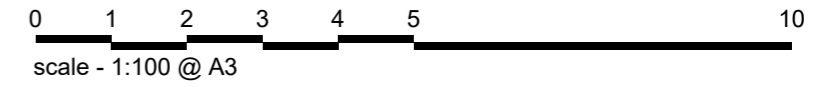

### CONCRETE QUANTITIES PLAN

scale - 1:100 @ A3



B	09.04.18	Updated plans for construction
A	09.04.18	Revised design for construction
No.	DATE	REVISION